

Ecology your way: a simple guide to your ecological year.

Connecting people with nature is at the heart of everything we do at Land Studio. Our in-house team of landscape architects, engineers and ecologists have outstanding experience in creating holistic solutions for our clients, which include the National Trust, landowners and developers across the country.

We have produced this guide to help you navigate the seasons, know when to undertake surveys and how to plan for developments in the following year. The guide is split to show two approaches, the first shows which surveys to undertake in a particular month and the second is a species by species guide. If you have any questions then please get in touch: **01244 319 019 / info@landstudio-uk.com**

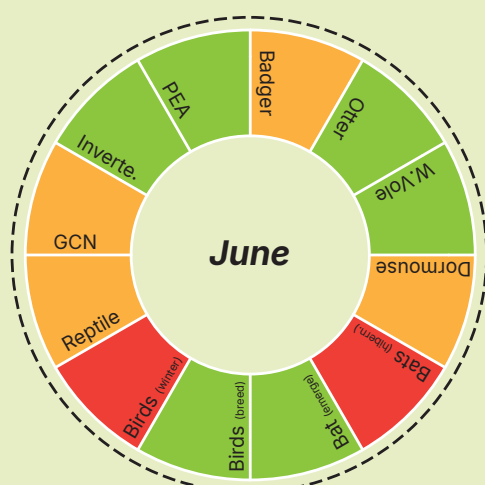

Survey times by month

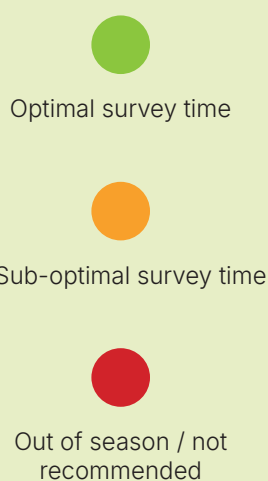

Survey times by species

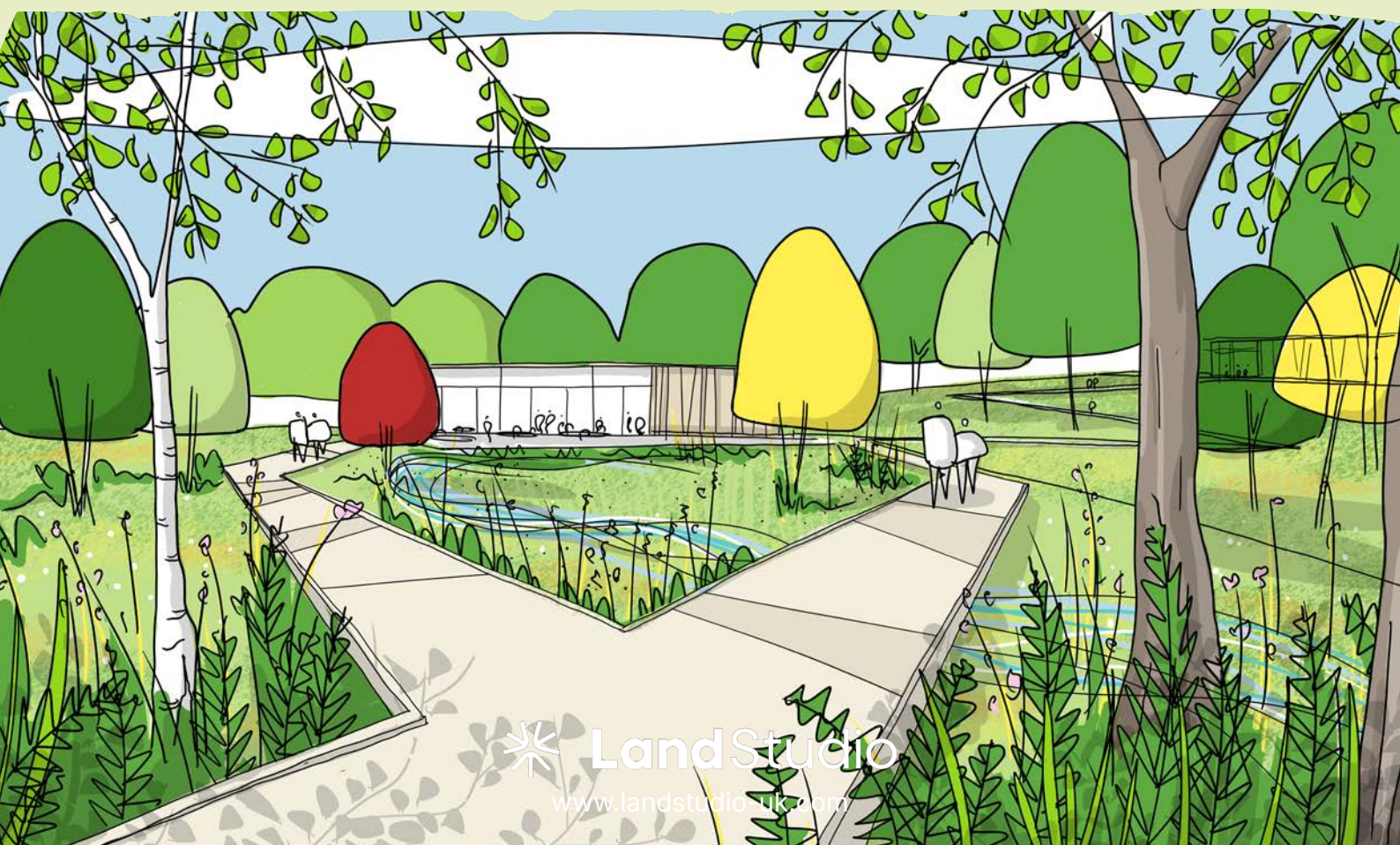

A year in review: Your month by month survey guide for key species.

The year at a glance, check the guide below in any given month to see when the optimal time for undertaking a specific species surveys is.

As a general rule, Preliminary Ecological Appraisals can be undertaken year round and are a useful way of scoping sites in winter for the forthcoming survey season. Newts, reptiles and water voles are the early spring season surveys closely followed by bats and breeding birds with badgers and otters able to be surveyed through the whole year.



Optimal survey time



Sub-optimal survey time



Out of season / not recommended

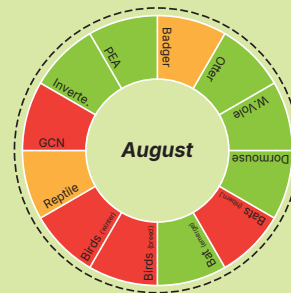
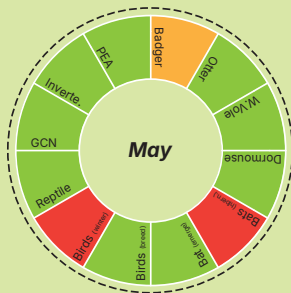
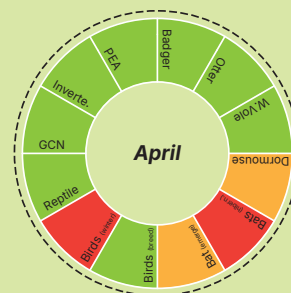

Which species, when?

Your species by species guide for optimum timing.

Many of our clients have specific species requirements that require surveys through the year from bats in unoccupied buildings to newts in nearby waterbodies.

The guide below takes you straight to each species to let you understand the optimal time of year to book in a survey to be undertaken. As described on the previous page, Preliminary Ecological Appraisals can be undertaken throughout the year with winter a particularly good time to scope out any potential surveys that may be required in the following year.



Optimal survey time



Sub-optimal survey time



Out of season / not recommended

